

East Sussex County Council Planning Committee 30 April 2025

WD/3517/CC– Grove Park School, Church Road, Crowborough TN6 1BN

The erection of a new Secondary School Building with associated outdoor learning and play space, landscaping and parking.

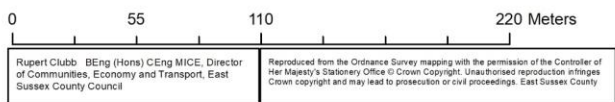

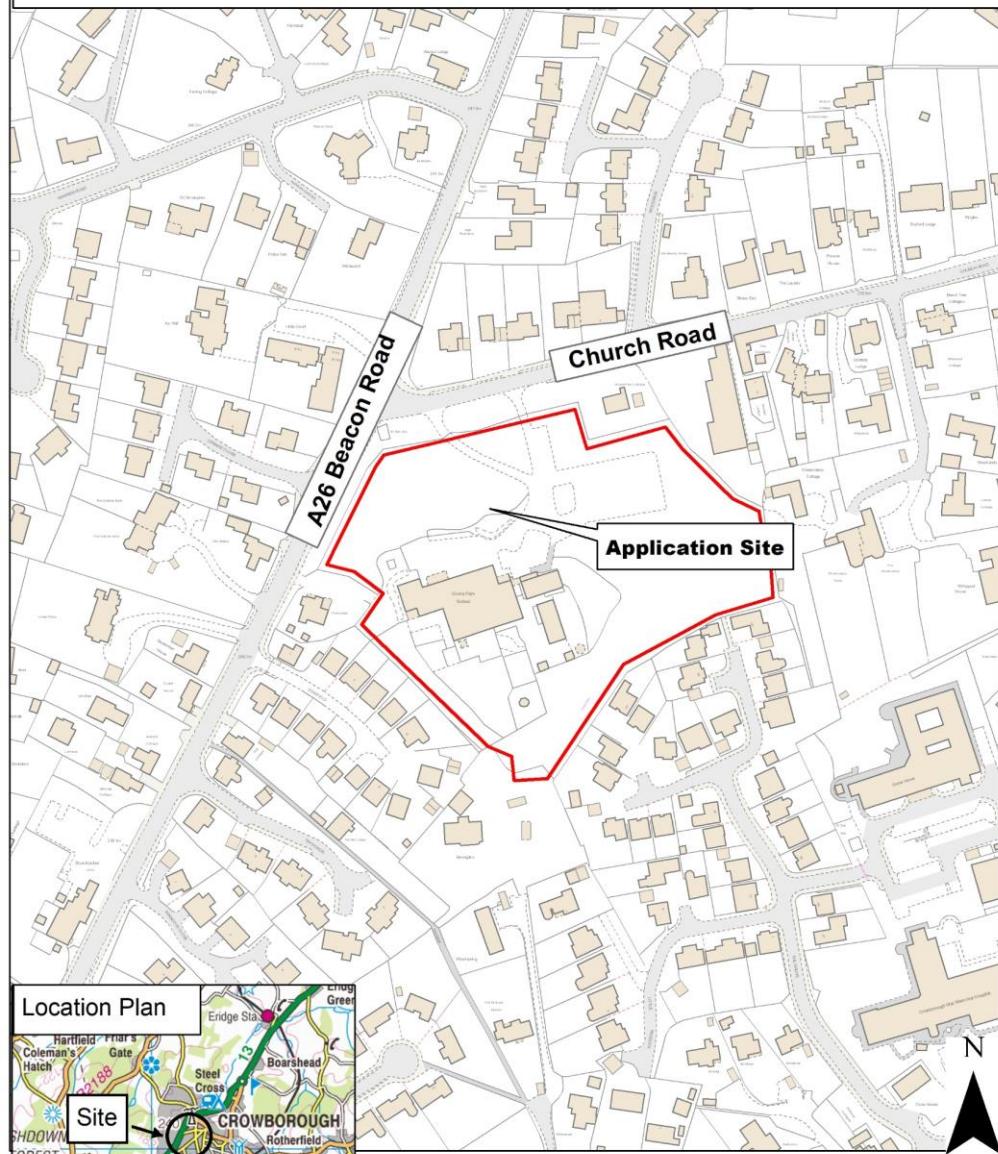
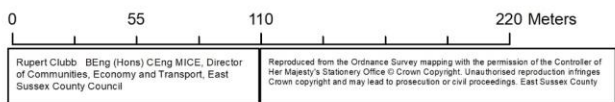
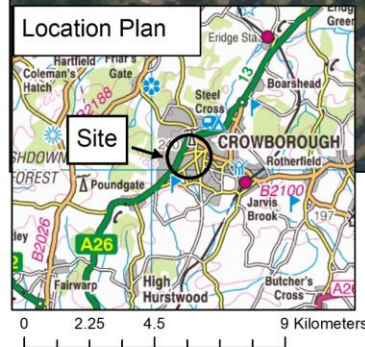



- Feasibility Options Key**
- Site Boundary
 - Proposed 2.0m high Fence between Buildings (Refer to GROV-WMA-00-00-01 - 1:1000 for Landscape Architect Proposal)
 - Proposed 2.0m high Fence and Gates (Refer to GROV-WMA-00-00-01 - 1:1000 for Landscape Architect Proposal)
 - Proposed 1.0m high Fence Panel (Refer to GROV-WMA-00-00-01 - 1:1000 for Landscape Architect Proposal)
 - Proposed Building 2 Storeys & Lower Ground Floor
 - Proposed Substation
 - Proposed Bin Store
 - Proposed Cycle Store
 - Hard Outdoor PE Area
 - Hard Informal and Social Area
 - Soft Informal and Social Area
 - Habitat Area
 - Proposed New Hardscaping
 - Existing Car Parking Provision
 - Proposed Car Parking
 - Proposed Accessible Car Parking
 - Proposed Entrances
 - Tree survey - Trees retained
 - Site survey
 - Existing electrical line crossing site
 - Proposed Secondary external play area
 - Existing Site Level (Refer to A3)

NOTE: Refer to Landscape drawings for full detail of hard and soft landscape.

NOTE: Refer to tree protection and removal plan for details of removed and protected trees.

Plan: as shown	Revised site plan	NY	DM
Plan: as shown	Revised planning shell	NY	DM
Plan: as shown	Stage 1 WDC form	NM	DM

ECE Architecture
www.ecearchitecture.com

10 Great Tollerly Street,
London, SE1 6LJ
Tel: 020 7461 1000
Email: info@ecearchitecture.com

Services: Working With Schools, DM 1/200
Planning, Design Team
Working With Schools, DM 1/200
Working With Schools, DM 1/200
Working With Schools, DM 1/200

WILLMOTT DIXON
SINCE 1925

East Sussex County Council

2024
Grove Park Secondary School

Drawing Title
Proposed Site Plan

Scale	1:500 @ A1 / 1:1000 @ A3
Project	GROV-ECE-XX-XX-D-A-0006_P08
Drawn	NY
Checked	DM
Date	28/06/2024

S8 - Planning Information

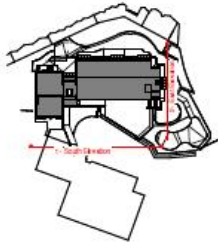

MAT 01	Facing brick (colour TBC)
MAT 02	PPC Aluminium Rainwater Pipe (colour TBC)
MAT 03	Painted Steel / Polycarbonate canopy (colour TBC)
MAT 04	Aluminium PPC Cladding Panel
MAT 05	Aluminium PPC Spandrel Panel
MAT 06	Waldmest Anticlimb Fence Panel
MAT 07	Thermally Broken PPC Aluminium (colour to match TBC)
MAT 08	Aluminium Curtain Walling System (colour to match window)
MAT 09	1/2" Solid Guarding System (blackened steel)
MAT 10	Aluminium Roof Cooing (colour to match window)
MAT 11	PPC Aluminium Louvres as part of Window System (colour to match window)
MAT 12	PPG Acoustic Plant screen louvres. (colour TBC)
MAT 13	Galvanised Steel Handrails

 **ECE Architecture**
www.ece-arch.co.uk

London: c/o Canal Souths Street,
London SE1 1DL
T 020 7 406 4771 & 7 406 4772 e info@ece-arch.co.uk

Barnes: 54 St Stephen Road,
Worthing West Sussex, BN1 2JY
T 01323 420 271 & 01323 420 272 e info@ece-arch.co.uk

Stratford: Walsworth, Jackson Tower,
Colston Street, Bristol, BS1 4LT
T 0117 414 1101 e info@ece-arch.co.uk

 **East Sussex
County Council**

 **WILLIAMITT DIXON**
SINCE 1900



Job Title
Grove Park Secondary School

Drawing Title
Colour Elevations - South and East

Scale
1:100 @ A1 / 1:200 @ A3

Project	Organization	Zone	Level	Type	Class	Proj. No.	Rev.
GROV - ECE-XX- ZZ - D - A- 0410 P06							
Drawn	Checked	Date					
NY	DM	23/08/24					



GIA Schedule	
Name	Area
Lower Ground Floor GIA	254 m ²
Ground Floor East GIA	612 m ²
Ground Floor West GIA	254 m ²
First Floor GIA	621 m ²
	1740 m ²

Room Use Key

Net Areas

- Classroom
- Learning Resource
- Staff & Admin
- Halls
- Storage

Net Areas

- Circulation, Plant, Toilets and Personal Care

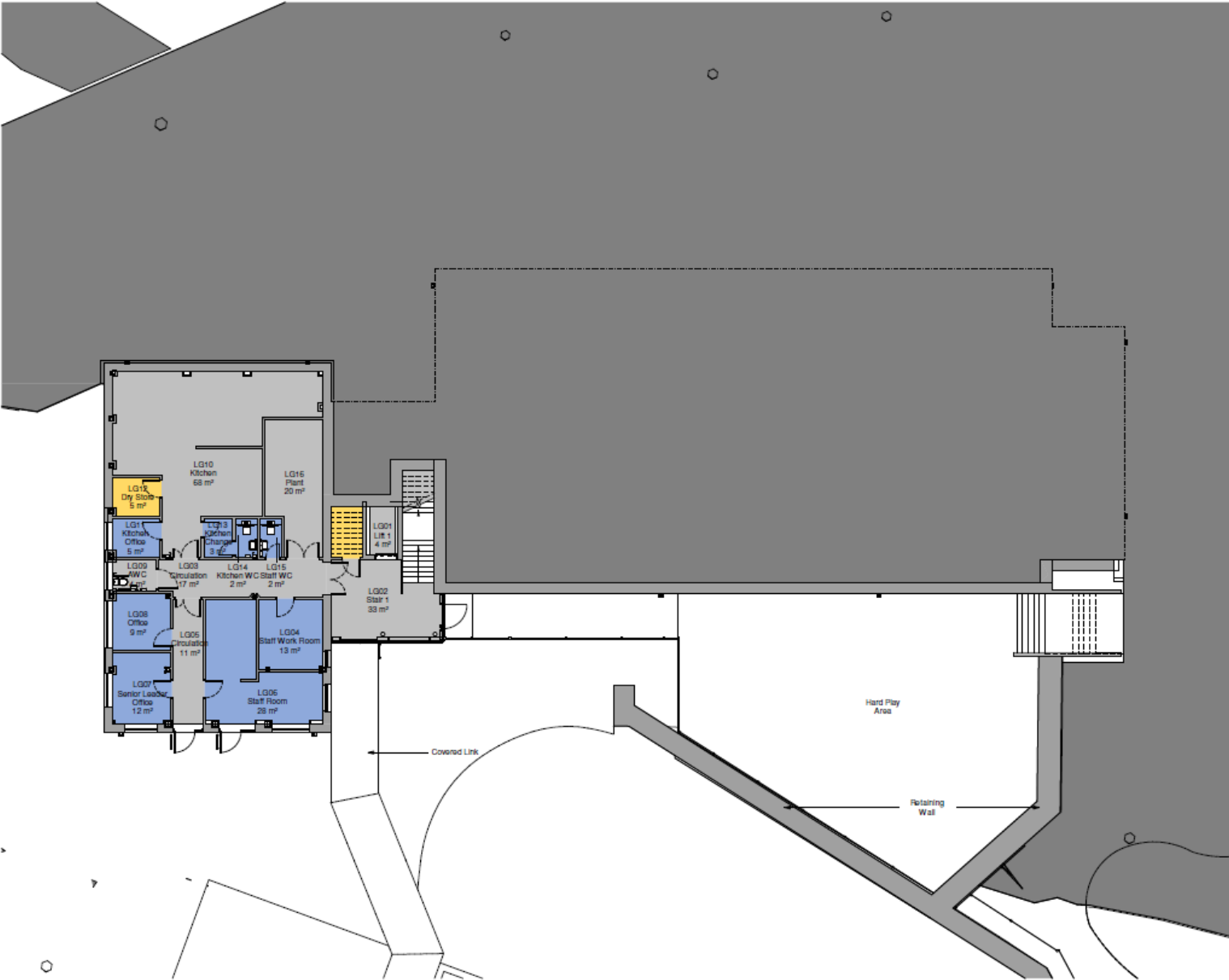



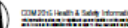

Proj: 2010-2011	Revised planning sheet	NY	CR	
Plan: 10-12-2010	Stage 1 WDC issue	NW	CR	
Plan: 20-11-2010	Planning issue	NY	CR	
Row	Date	Flow/plan Details	Dr	CR

9



Room Use Key

Not Answered

-  Classroom
-  Learning Resource
-  Staff & Admin
-  Halls
-  Storage

Not Applicable

- ☐ Circulation, Plant, Toilets and Personal Care

Flow	Date	Flow/Inlet Details	Dr	Cl
------	------	--------------------	----	----

Flow	Date	Flow/Inlet Details	Dr	Cl
------	------	--------------------	----	----

Flow	Date	Flow/Inlet Details	Dr	Cl
------	------	--------------------	----	----



ECE Architecture
www.ecearchitecture.com



Job Title
Grove Park Secondary School

Drawing Title
Ground Floor Plan

1:100 @ A1 / 1:200 @ A3

Project	Originator	Zone	Level	Type	Dept.	Op. No.	Rev
GROW-ECE-XX-00-D-A-0102_P11							
Drawn	Checked						
NY	DM					10/14/24	

S8 - Planning Information

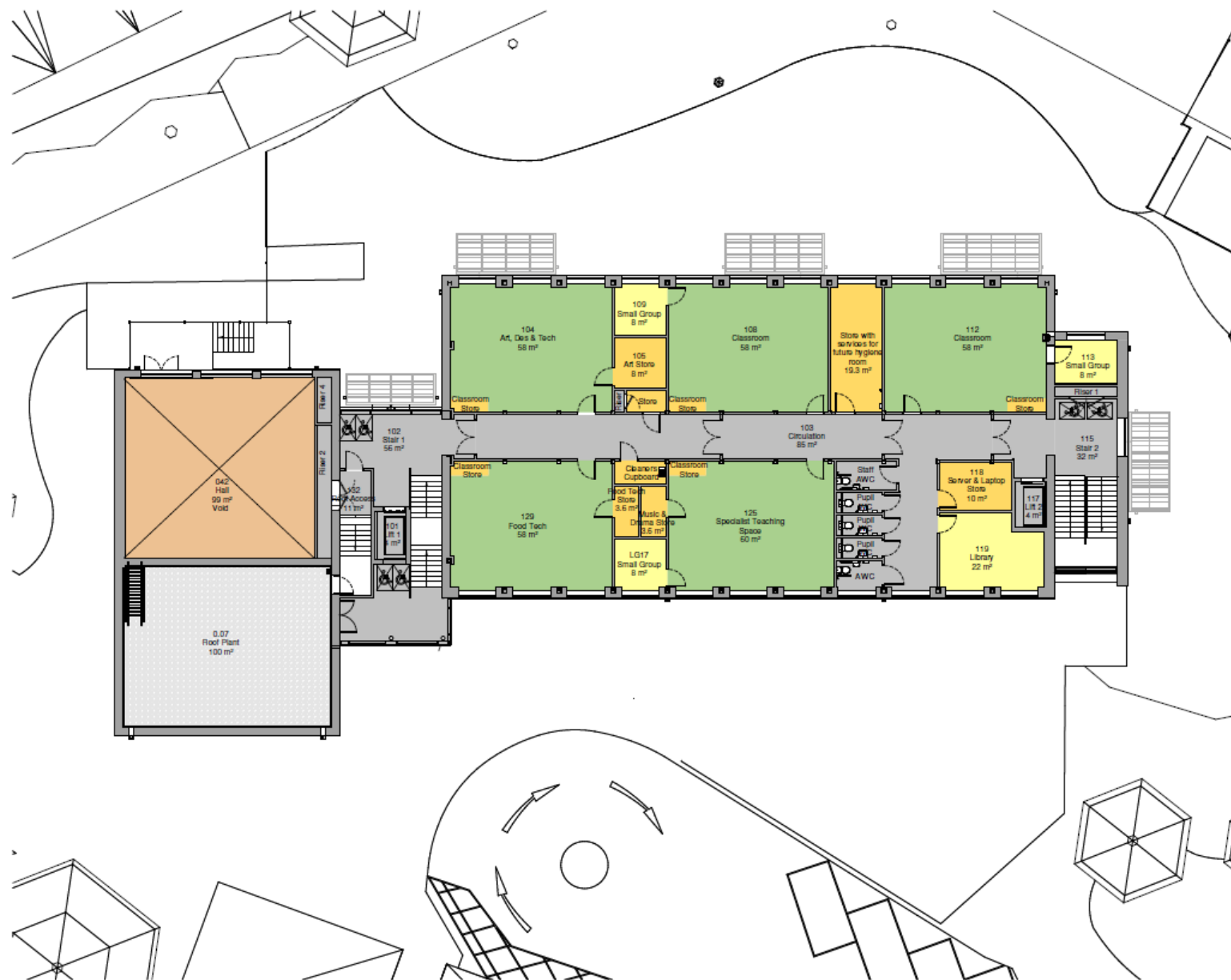

GIA Schedule	
Name	Area
Lower Ground Floor GIA	254 m ²
Ground Floor East GIA	613 m ²
Ground Floor West GIA	254 m ²
First Floor GIA	621 m ²
	1740 m ²

- Room Use Key**
- Net Areas**
- Classroom
 - Learning Resource
 - Staff & Admin
 - Halls
 - Storage
- Net Areas**
- Circulation, Plant, Toilets and Personal Care

Plan	As shown	Revised planning sheet	NY	DM
Plan	As shown	Stage 1 WCC issue	NY	DM
Plan	As shown	Planning issue	NY	DM

Rev	Date	Description Details	Dr	Ch
-----	------	---------------------	----	----

London
10 Great South Street, London SE1 8AA
T: 020 7461 0000 or 020 7461 0001
www.ece-architecture.com
Bristol
10 The Arcade, Bristol BS1 1JF
T: 0117 333 0000 or 0117 333 0001
www.ece-architecture.com
Birmingham
10 The Arcade, Birmingham B1 1JF
T: 0121 222 0000 or 0121 222 0001
www.ece-architecture.com

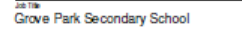

WILLMOTT DIXON
SINCE 1925

Job Title
Grove Park Secondary School

Drawing Title
First Floor Plan

GROV-ECE-XX-01-D-A-0103_P09						
Project	Originator	Zone	Level	Type	Date	Drawn
GROV-ECE-XX-01-D-A-0103_P09						
Drawn		Checked		Issued		
NY		DM		10/14/24		
Status						

S8 - Planning Information

WD/3517/CC - Grove Park School, Church Road, Crowborough, East Sussex, TN6 1BN

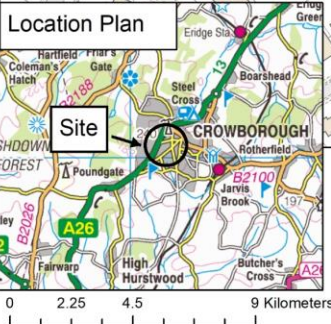
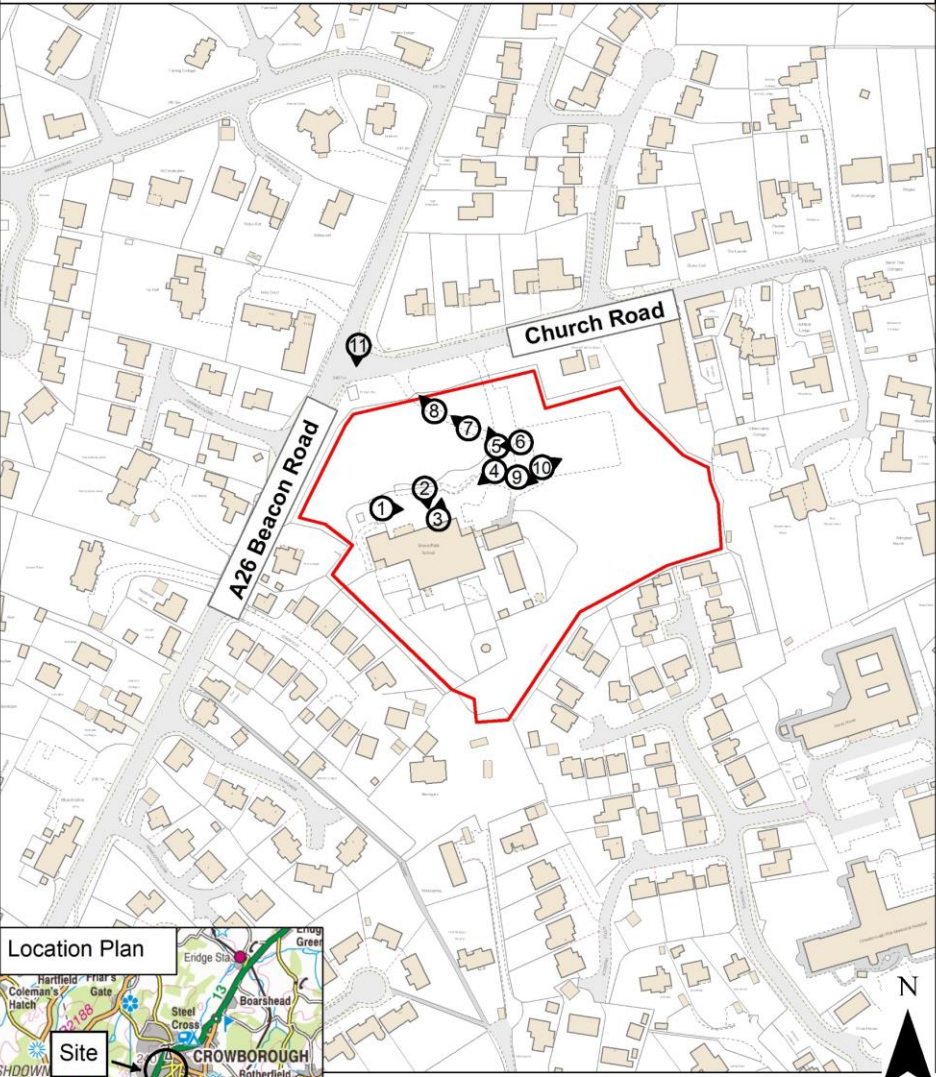

0 55 110 220 Meters

Rupert Clubb BEng (Hons) CEng MICE, Director of Communities, Economy and Transport, East Sussex County Council
Reproduced from the Ordnance Survey mapping with the permission of the Controller of Her Majesty's Stationary Office © Crown Copyright. Unauthorised reproduction infringes Crown copyright and may lead to prosecution or civil proceedings. East Sussex County Council























WD/3517/CC– Grove Park School, Church Road, Crowborough TN6 1BN

The erection of a new Secondary School Building with associated outdoor learning and play space, landscaping and parking.

East Sussex County Council Planning Committee 30 April 2025